

I:\4053.002A SLWSD General Services\Drawings\System Maps\SLWSD base msp.dwg, WATER 400, 4/12/2021 12:44:50 PM

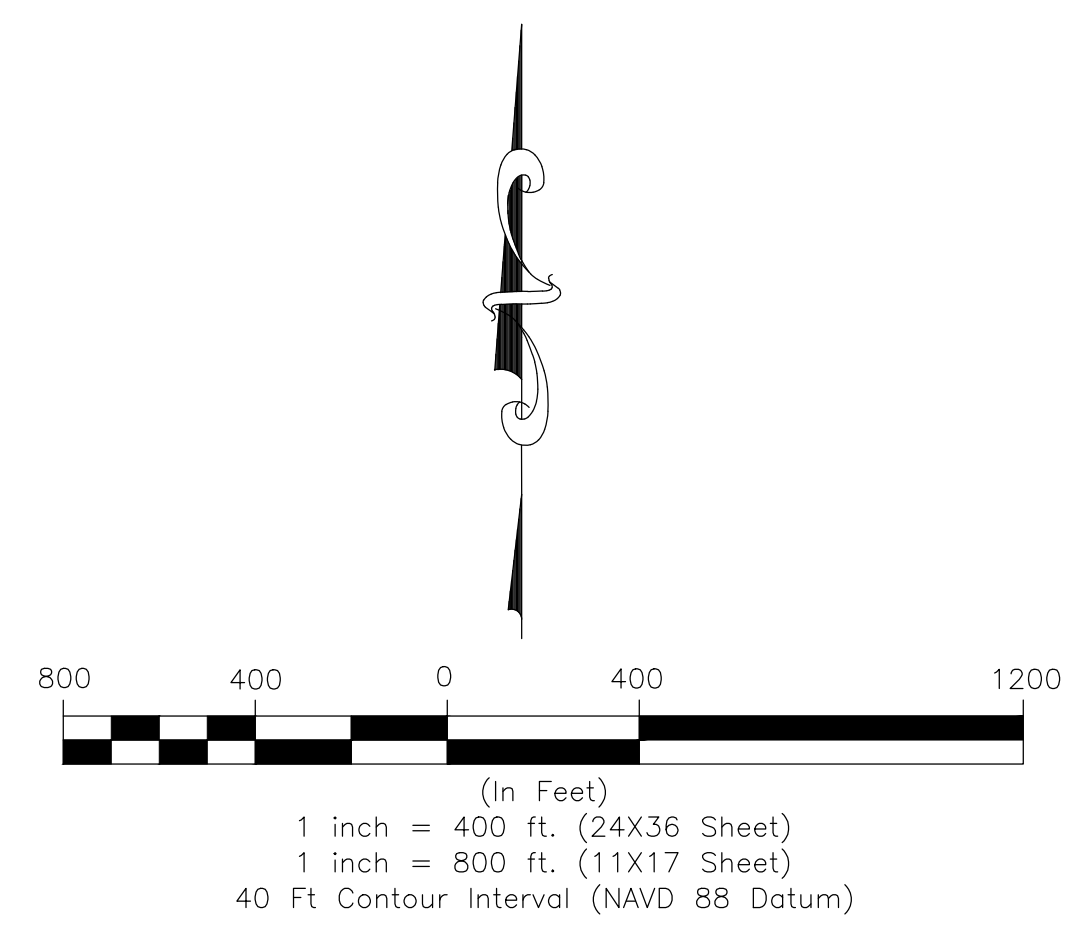
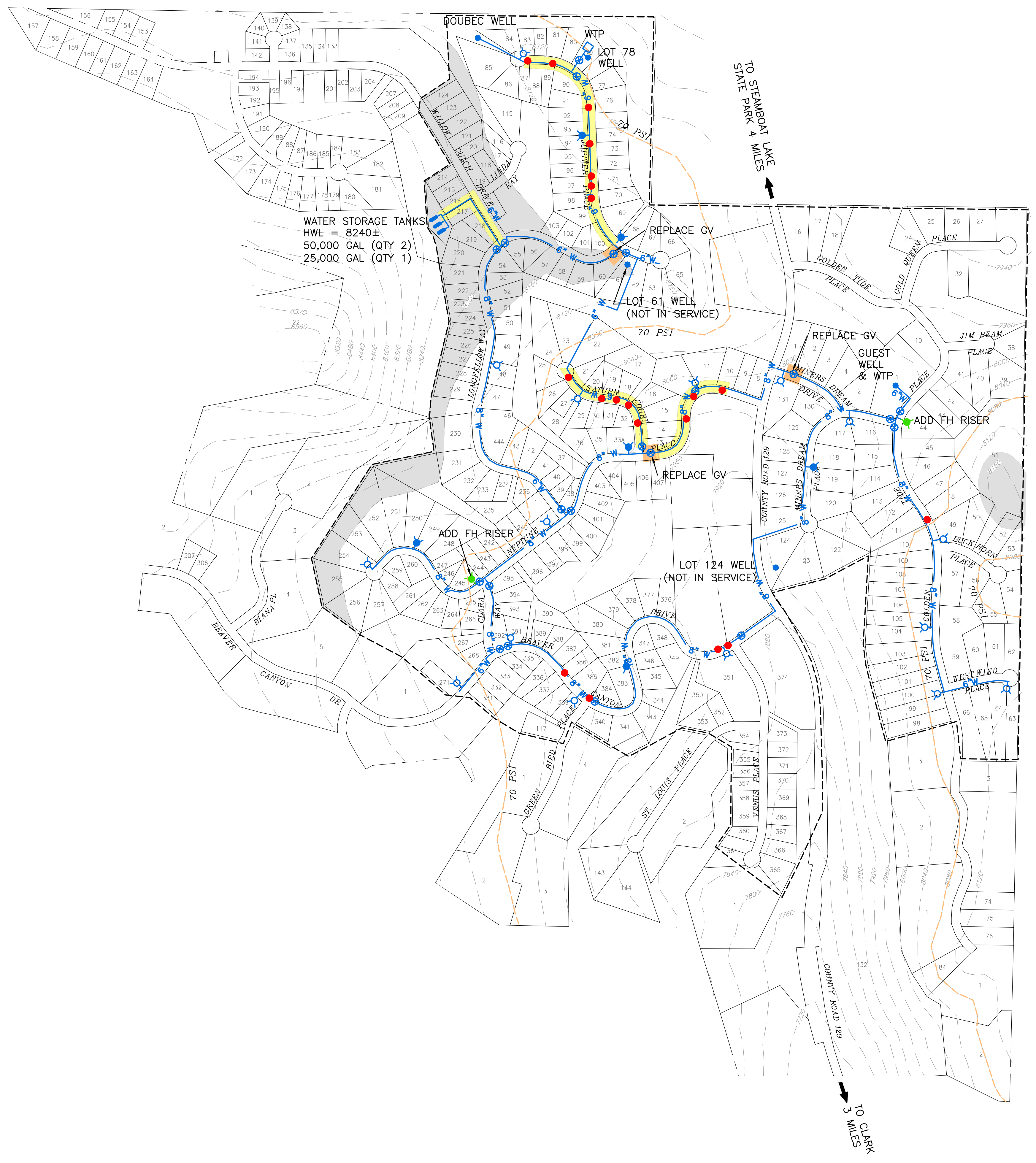

LEGEND

- WELL
- WTP
- WELL/WATER TREATMENT PLANT
- 6" W
- 8" W
- EXISTING 6" WATER AND FH
- EXISTING 8" WATER AND FH
- RECENT MAIN BREAKS (APPROXIMATE LOCATION)
- PRIORITY WATER MAIN IMPROVEMENT
- SERVICES BELOW THIS ELEVATION REQUIRE INDIVIDUAL PRVs
- LOW PRESSURE AREA (<35 PSI): BUILDINGS IN THIS AREA MAY REQUIRE SPECIAL PLUMBING DESIGN OR BOOSTER PUMPING
- APPROXIMATE DISTRICT SERVICE AREA
- FH TO BE REPLACED (QTY 6)
- FH ADD RISER EXTENSION (QTY 2)
- GV TO BE REPLACED (QTY 3)

Date: 4/12/21	STEAMBOAT LAKE WATER & SANITATION DISTRICT DISTRICT SERVICE AREA WATER SYSTEM MAP
Drawn: LM	
Designed:	
Scale: As Noted	
Civil Design Consultants, Inc. Civil and Environmental Engineers 2130 Resort Drive, Suite 200 Steamboat Springs, CO 80487 Tel (970) 879-3022	
Project No. 4053.002A	Sheet No. C-100